



Akashneem PALMS



Akashneem PALMS

**Creating Homes Where
moments become
memories.**



YOUR OASIS AWAITS AT AKASHNEEM





Aerial View

Here
Comfort
Meets
Elegance



KIDS
Play Area

MEDITATION Garden



Multi-purpose TURF

AMENITIES



Roman isle garden



Cricket pitch

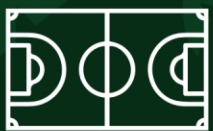

Multi-purpose turf



Mini golf



Party lawn



Kids play area



Trellis garden



Butterfly garden



Meditation garden



Herbs garden



Temple



Blossom garden



Mounds garden





BUTTERFLY
Garden



MOUNDS
Garden



SELFIE
Point



SELFIE
Point

PROPOSED 75 MT WIDE ROAD

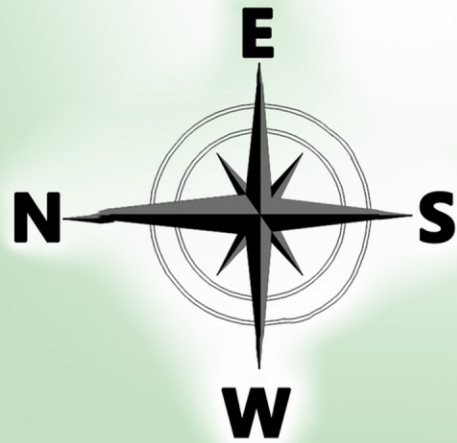

LAYOUT PLAN

Akashneem
PALMS

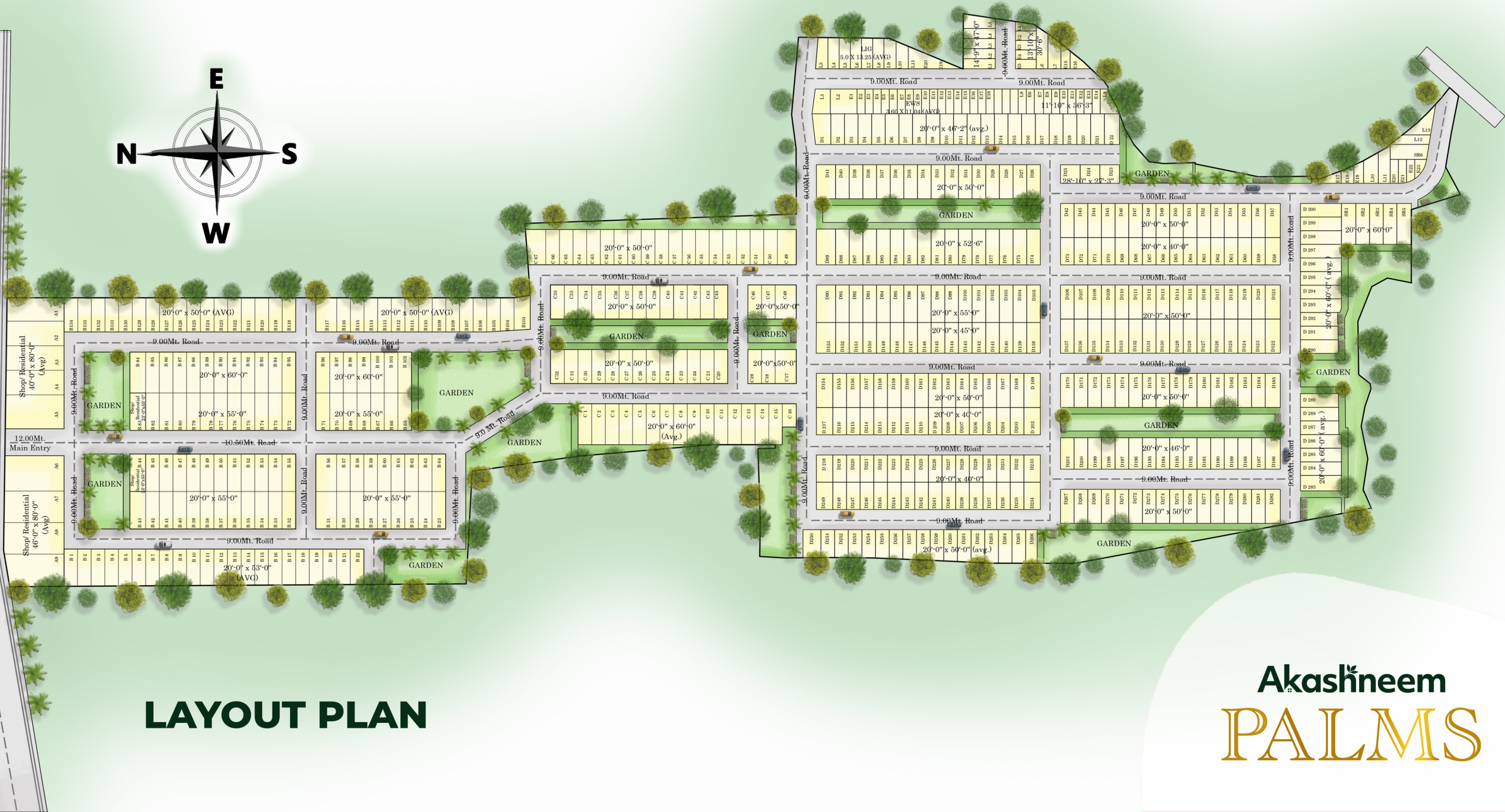



KEY DISTANCES

ROAD CONNECTIVITY

- ▶ 3 major proposed roads (two 75 m and 45 m connects to the land
- ▶ Adjoining AKVN Economic Corridor including IT Park, Start-ups, Hotel, Stock Exchange and other business places near the project
- ▶ On the road connecting Airport to Pithampur
- ▶ Near upcoming MP's MMPLP (logistic park)
- ▶ Well connectivity to Super Corridor
- ▶ Metro Station (10min)

AIRWAYS

- ▶ Devi Ahilya Bai Holkar Airport (10min)

SCHOOL

- ▶ St. Mary champion (5min)
- ▶ Vidhyanjali international (8min)
- ▶ Omni school (8min)
- ▶ Delhi International (10min)
- ▶ Vedansh international (15min)

OUR PROJECTS

- ▶ Balaji vihar (1min)
- ▶ Sumeru hills (15min)

HOSPITALS

- ▶ Sri Aurobindo Hospital (25min)
- ▶ M.Y. Hospital (30 min)
- ▶ Choithram Netralaya (5min)
- ▶ Arihant hospital and reserch centre (15min)

SIGHT SEEING

- ▶ Bijasan Mata mandir(10-12 min)
- ▶ Grand Machal (10-12min)
- ▶ Gulawat (30min)
- ▶ Yashwant Sagar Dam (30-35min)

Project By



Exclusive Marketing Partner



Site: Akashneem Palms, Nawdapanth
9179205340, 9238622992 | www.rareventures.in

Rera No.:
P-IND-24-4494

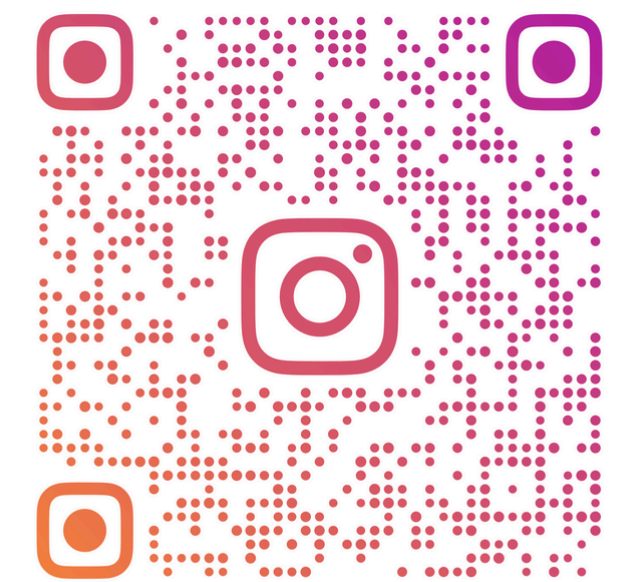

[RAREVENTURES.REALTORS](https://www.rareventures.in)

Disclaimer: The images, renderings, and layout diagrams featured in this brochure are for illustrative purposes only and are subject to change without prior notice. The developer reserves the right to make modifications, revisions, and adjustments to the plans, designs, amenities, and specifications of the township as deemed necessary. All dimensions, areas, and distances mentioned are approximate and may vary from the actual site. Prospective buyers are advised to verify all information and details before making any decisions.